

50-80-100 kg/24 h

 Cubetto / Cube / Glaçons / Cubitos  
18 gr

CIM 50/25

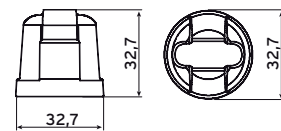
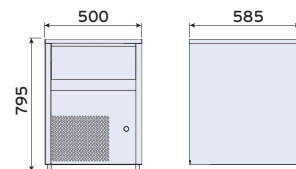
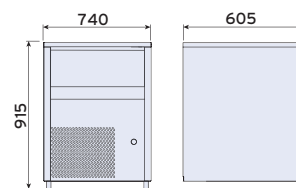

CIM 80/40

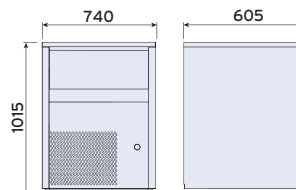

CIM 100/60



- Costruzione in acciaio inox e materiali idonei al contatto con gli alimenti
- **Vasca raccolta ghiaccio integrata**
- Gas R404a
- Condensazione (A) aria o (W) acqua
- Controlli elettronici
- Voltaggi speciali, su richiesta
- Macchine rispondenti alle normative di igiene e di sicurezza in vigore
- **Condizioni di lavoro standard:**  
temperatura acqua 15°C  
temperatura ambiente 20°C
- Consigliata installazione sistema dosatore sale anticalcare



- *Construction in stainless steel and specific materials approved for contact with food stuff*
- **Self contained ice collecting bin**
- Gas R404a
- (A) Air or W (Water) condensing
- Electronic controls
- Special voltages, on request
- Machines comply with hygiene and safety regulations
- **Standard working conditions:**  
incoming water temperature 15°C  
environment air temperature 20°C
- Highly recommended the installation of salt dosing unit to prevent scale built-up of limestone



- Construction en acier inox et matériaux pour aliments
- **Bac à glace incorporée**
- Gaz R404a
- Condensation (A) air ou (W) eau control électronique
- Tensions spéciales, sur demande
- Machines conformes aux normes en vigueur en matière d'hygiène et de sécurité
- **Conditions de travail standard:**  
température eau 15°C  
température environnement 20°C
- Une unité de dosage de poudre pour empêcher le calcaire est fortement recommandée



- *Estructura de acero inoxidable y materiales para alimentos*
- **Cuba recolección hielo incorporada**
- Gas R404a
- Comandos electrónicos condensación (A) aire o (W) agua
- Voltajes especiales a petición
- Máquinas conformes a las normas vigentes en materia de higiene y seguridad
- **Condiciones de trabajo standards:**  
temperatura entrada agua: 15°C  
temperatura ambiente: 20°C
- Recomendado instalación sistema dosificador de sales para evitar incrustaciones de calcio

	CIM 50/25	CIM 80/40	CIM 100/60
Produzione - Productivity Production - Producción	50 kg/24 h 2941 cubetti/cubes/glaçon/cubitos	80 kg/24 h 4705 cubetti/cubes/glaçon/cubitos	100 kg/24 h 5882 cubetti/cubes/glaçon/cubitos
Capacità deposito - Storage capacity Capacite bac - Capacidad depósito	25 kg 1470 cubetti/cubes/glaçon/cubitos approx	40 kg 2352 cubetti/cubes/glaçon/cubitos approx	60 kg 3529 cubetti/cubes/glaçon/cubitos approx
Potenza elettrica - Electrical Power Puissance électrique - Potencia eléctrica	0,8 kW	0,9 kW	1,0 kW
Peso netto - Net weight - Poids net - Peso neto	55 kg	72 kg	87 kg
Tensione nominale - Volt Rated Tension nominale - Tensión nominal	V230/1/50Hz	V230/1/50Hz	V230/1/50Hz

ACCESSORI - ACCESSORIES - ACCESSOIRES - ACCESORIOS (pag. 27-30)

